



HCCM  
HORSEGLASS PRODUCTS LTD.

6224 29th Street SE  
Calgary, Alberta T2C 1W3  
TEL (403) 236-7738  
FAX (403) 287-7728

NO.	DATE	BY	REVISION

MODULAR BUILDING - MV  
SERIES  
(8'W X 8'L X 12'H)

CLIENT INFO  
-  
-  
-  
-

DESIGN BY	DB	DESIGNED BY	REVIEWED
SCALE	NTS	DATE	2010/12/20

CLIENT APPROVAL  
SIGNATURE

DATE

SCALE FOR REVIEW	PROJECT NO. X
------------------	---------------

DWG1

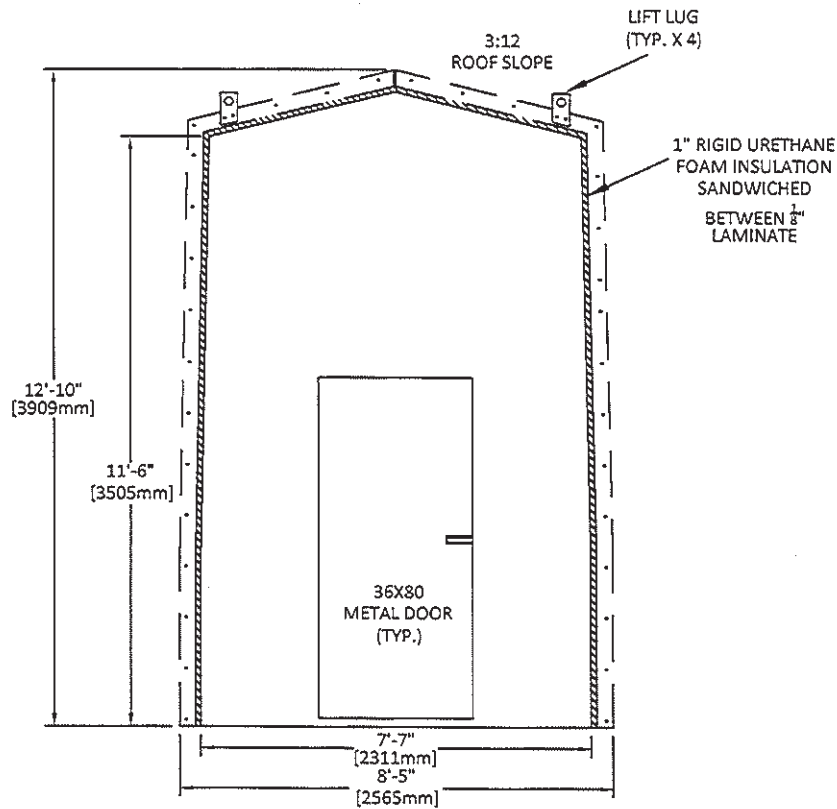

**FRONT ELEV.**

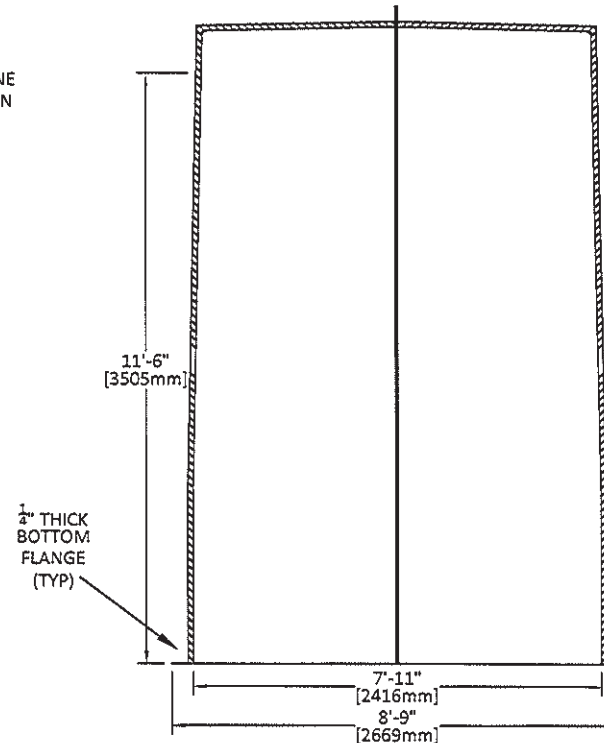

**RIGHT ELEV.**

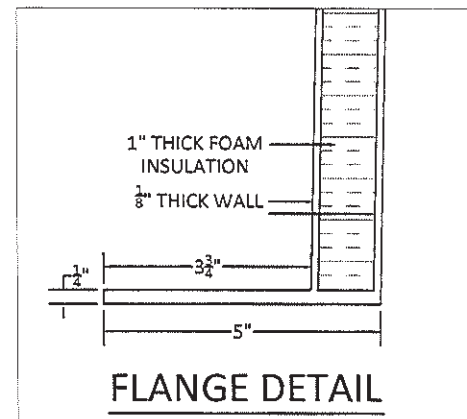

**FLANGE DETAIL**

\*\*\*ALL DIMENSIONS NOMINAL\*\*\*